

# PRODUCT CATALOG

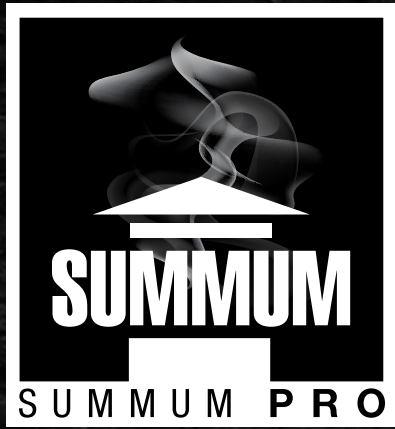

\* Pictures for information only.

**Stainless 304 / 304**  
INSIDE / OUTSIDE  
Certified according to the standard  
**CAN/ULC-S629, 2100°F.**





## PREMIUM DISTRIBUTION

### ABOUT US

**PREMIUM DISTRIBUTION**, it is a whole new distributor of residential chimneys in Canada and offers **SUMMUM PRO** products.

**SUMMUM PRO** is a multi-fuel system tested and certified by OTL Omni Test Laboratories inc, for equipment that requires **CAN/ULC-S629-M87 (R1997)** including; stoves, wood stoves, fireplaces and oil-burning appliances, gas or coal.

With its chimney of impeccable workmanship and exceptional quality, combined with more than competitive prices, **PREMIUM DISTRIBUTION** shows that the name **SUMMUM PRO** is has become a must in the chimney market.

Alain Robitaille, Président.



Suivez-nous sur Facebook

ABOUT US	2
CONTENT	3
CHARACTERISTICS	
CERTIFICATE .....	4
APPLICATIONS .....	4
MATERIALS AND CONSTRUCTION .....	4
SPACE CLEARANCE .....	4
DIAMETERS .....	4
PIECES	
CHIMNEY LENGHT .....	5
ELBOW (2 pcs) .....	6
LOCKING BAND .....	7
OFFSET SUPPORT .....	7
TEE WITH CAP .....	8
TEE CAP WITH HANDLE .....	8
TEE CAP WITH DRAIN .....	9
ADJUSTABLE WALL SUPPORT AND TEE BRACKET 5" .....	9
ADJUSTABLE WALL BRACKET 16" .....	10
ADJUSTABLE TEE SUPPORT 16" .....	10
FIRESTOP WITH RADIATION SHIELD .....	11
INSULATED AND ADJUSTABLE ATTIC SHIELD .....	11
INSULATED ROOF RADIATION SHEILD (CATHEDRAL) .....	12
ROOF SUPPORT .....	12
VENTED ROOF FLASHING .....	13-14
VENTED AND ADJUSTABLE PEAK FLASHING .....	15
EXTENDED ROOF BRACKET .....	15
STORM COLLAR .....	16
STORM COLLAR XL .....	16
FLUE EXTENSION .....	17
INSULATED SQUARE CEILING SUPPORT .....	17
ROUND CEILING SUPPORT .....	18
INSULATED ROUND CEILING SUPPORT .....	18
BLACK FINISHING TRIM .....	19
INSULATED WALL THIMBLE .....	19
ROOF RADIATION SHIELD .....	20
RAIN CAP WITH SHIELD .....	20
VARIOUS PARTS .....	21
OUTDOOR STARTING KIT .....	22
INDOOR STARTING KIT .....	23
CATHEDRAL STARTING KIT .....	23
INSTALLATIONS	
CATHEDRAL INSTALLATIONS .....	24
CATHEDRAL INSTALLATIONS IN THE BASEMENT .....	25
ONE STOREY INSTALLATION WITH CEILING SUPPORT .....	26
TWO STOREY INSTALLATION WITH CEILING SUPPORT .....	27
THREE STOREY INSTALLATION WITH CEILING SUPPORT .....	28
EXTERNAL INSTALLATION WITH WALL BRACKET EXTENSION .....	29
EXTERNAL INSTALLATION THROUGH THE ROOF EXTENSION .....	30
INSTALLATION WITH DEFLECTION .....	31

## CERTIFICATE

Certified according to the standard CAN/ULC-S629-M87 (R1997)  
by OMNI-LAB

## APPLICATIONS

The all-fuel chimney system **SUMMUM PRO** (6") is suitable for use with the following devices: convient à l'utilisation des appareils ci-dessous:

- Wood stoves
- Fireplaces
- Furnaces
- Ovens
- Water heater

\*Other residential appliances burning coal, oil, gas or wood

## MATERIALS AND CONSTRUCTION

**Exterior** : .019" SUS 304 / 304 stainless steel

**Interior** : .019" SUS 304 / 304 stainless steel

**Insulation** : 1.5" ceramic fibre offering superior insulating qualities

## SPACE CLEARANCE

Minimum clearance of 2" to combustible materials

## DIAMETERS

6"



\* Images for information only.

CHIMNEY LENGHT

**TWIST LOCK** technology allows **SUMMUM PRO** chimney lengths to be locked together and use an included locking band to secure the connection. No screws are required to secure the lengths in place. **SUMMUM PRO** offers chimney lengths from 48", 24", 18", 12", 9", 6".

PERMISSIBLE FLUE GAS TEMPERATURES		
MODEL	6"	
CONTINUOUS MAXIMUM	650°C	1200°F
FORCED COMBUSTION - 60 MINUTES	925°C	1700°F
TESTED AT - 3 X 30 MINUTES	1150°C	2100°F



- The **TWIST LOCK** plug-in system with clamp requires no screws allows for a quick and secure installation
- **PROFESSIONAL QUALITY MATERIALS**  
304 Stainless steel inside/outside with mirror finish
- **CONTINUOUS INVISIBLE WELDING**
- Thanks to its .019" thick walls, the **SUMMUM PRO** is **15% to 25% thicker than the competition** and the strongest on the market, which gives it a higher resistance to chimney fires
- **SUPERIOR INSULATION**  
1.5" thick ceramic fiber



CHIMNEY LENGHT

48" : SC-6SS48    24" : SC-6SS24  
18" : SC-6SS18    12" : SC-6SS12  
9" : SC-6SS9      6" : SC-6SS6

side view

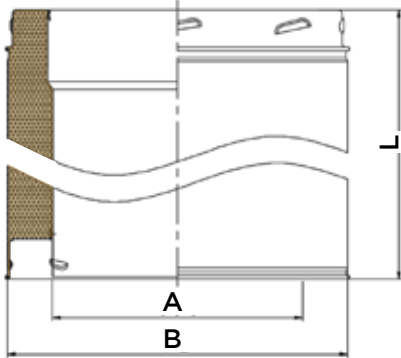

 = PIECE WITH INSULATION

Inch	A	B	L
6"	6"	9"	48", 24", 18", 12", 9", 6"



ELBOW\* (2 pcs)

Set of 2 **SUMMUM PRO 304 stainless steel indoor/outdoor** elbows including Locking bands. Certified according to the standard CAN/ULC-S629-M87 (R1997).



**ELBOW** (2 pcs)  
SC-6EL15 • SC-6EL30 • SC-6EL45  
\*(Included: Locking Bands)

side view

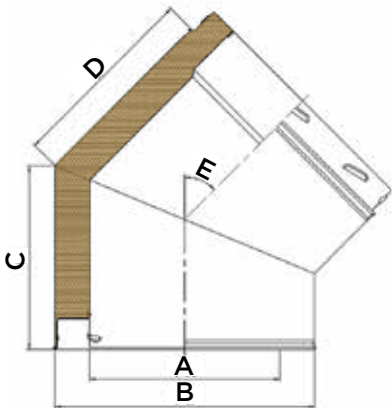

 = PIECE WITH INSULATION

Inch	A	B	C	D	E
6"	6"	9"	4 1/2"	5"	15°
			5 3/4"	6"	30°
			7"	7 1/2"	45°



LOCKING BAND

The locking band is designed to secure the chimney connector. After locking sections of **SUMMUM PRO** chimney, the locking band is wrapped around the joint and provides additional safety.



LOCKING BAND  
SC-6LB

top view

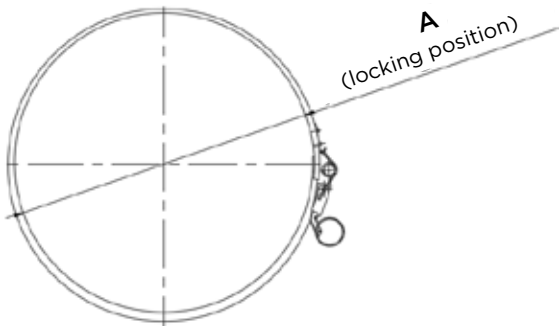

Inch	A
6"	9"

OFFSET SUPPORT

Required between two elbows to support the chimney weight created by the offset. It can be installed when the chimney exceeds the weight limit on the main support or when the **SUMMUM PRO** chimney exceeds the required height of the primary support. The two straps of the support are 24 inches in length. **304 Stainless steel** band with galvanized steel fastening straps.



OFFSET SUPPORT  
SC-6ELS-2

top view

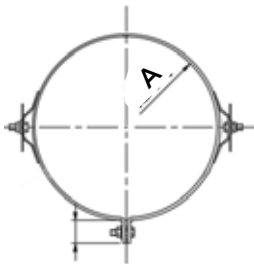

side view

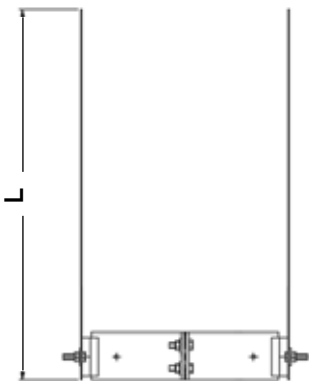

Inch	A	L
6"	9"	24"

### TEE WITH CAP\*

The **SUMMUM PRO** insulated tee can be installed inside or outside a structure. Install with a wall support or tee support assembly. The tee cover is included and easy to remove simply by unscrewing it counterclockwise. Nothing easier for inspection and cleaning.



### TEE WITH CAP\*

SC-6T90

\*(Included: locking bands)

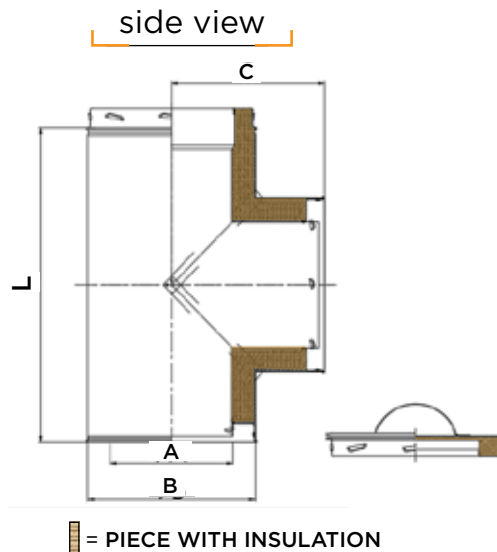

Inch	A	B	C	L
6"	6"	9"	8 3/4"	17 3/4"

### TEE CAP WITH HANDLE

The tee cap with handle is supplied with the **SUMMUM PRO** insulated tee and locks to the tee with **TWIST LOCK** technology.



### TEE CAP WITH HANDLE

SC-6T90C

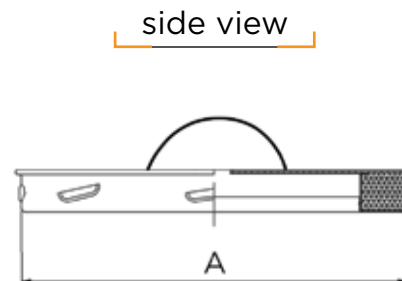

Inch	A
6"	9"



TEE CAP WITH DRAIN

Made of **304 stainless steel**, the **SUMMUM PRO** tee cap with drain (optional) must be placed at the base of an insulated tee to allow evacuation of rainwater and condensation. Also allows access for maintenance and inspection of the chimney.



TEE CAP WITH DRAIN  
SC-6T90W

side view

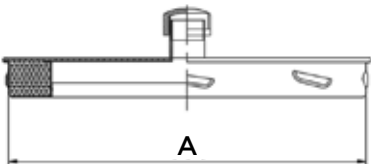

Inch	A
6"	9"

ADJUSTABLE WALL SUPPORT AND TEE BRACKET 5"

The adjustable wall support and tee bracket is used to support a vertical **SUMMUM PRO** chimney that passes through a wall. It settles on the first **SUMMUM PRO** chimney length, above the tee. A adjustable wall support and tee bracket is also used as side support and is required every 8 feet with a minimum of 2 brackets per system. **304 Stainless steel** band with galvanized mounting brackets.

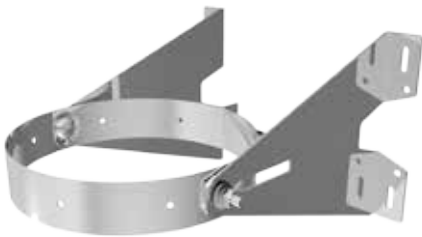

ADJUSTABLE WALL SUPPORT AND  
TEE BRACKET 5"  
SC-6AWB

top view

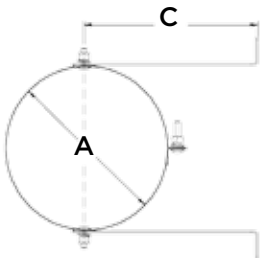

side view

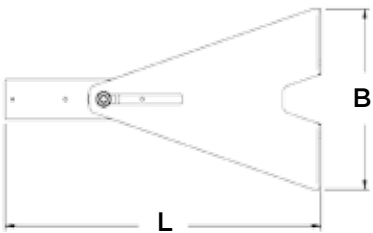

Inch	A	B	C	L
6"	9"	8"	10"	14"

ADJUSTABLE WALL BRACKET 16"

The adjustable wall bracket allows a 16" extension at the **SUMMUM PRO** chimney. It eliminates the need to deflect the **SUMMUM PRO** chimney around the eaves and avoids cutting the fascia and soffit. **304 Stainless steel** band with galvanized mounting brackets.



top view

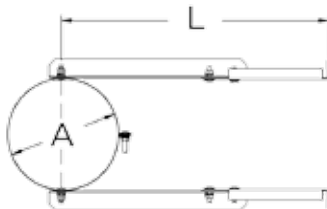

side view

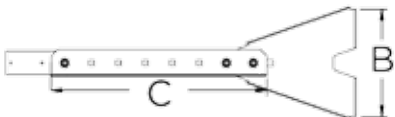

ADJUSTABLE WALL BRACKET 16"  
SC-6AWB16

Inch	A	B	C	L
6"	9"	8"	16"	21 3/4"

ADJUSTABLE TEE SUPPORT 16"

The adjustable tee support allows a 16" extension at the **SUMMUM PRO** chimney. It eliminates the need to deflect the **SUMMUM PRO** chimney around the eaves and avoids cutting the fascia and soffit. **304 Stainless steel** band with galvanized mounting brackets.



top view

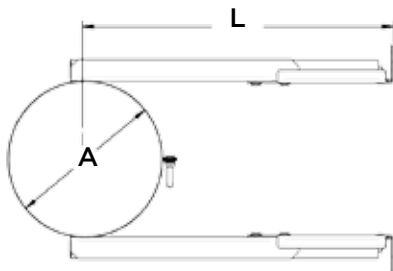

side view

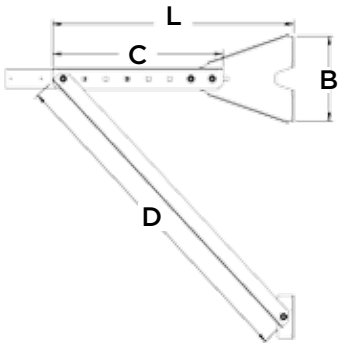

ADJUSTABLE TEE SUPPORT 16"  
SC-6ATS

Inch	A	B	C	D	L
6"	9"	8"	16"	31 1/4"	22 3/4"



FIRESTOP WITH RADIATION SHIELD\*

The **SUMMUM PRO** firestop with radiation shield is used to keep any combustible material from coming into contact with the chimney pipe.



FIRESTOP WITH RADIATION SHIELD\*  
SC-6FRS-2  
\*(Included: Collar)

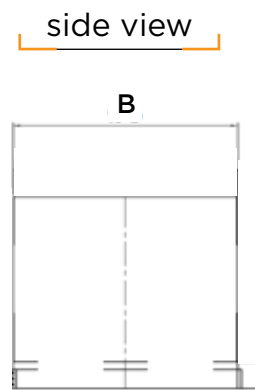
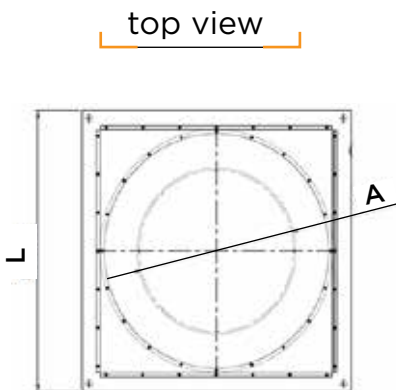

Inch	A	B	L
6"	9"	13"	15 3/8"

INSULATED AND ADJUSTABLE ATTIC SHIELD\* (10" a 19")

The **SUMMUM PRO** insulated and adjustable attic shield It is used to keep any combustible material from coming into contact with the chimney pipe. It must be placed under the ceiling of the attic. Make sure to keep 2" clearance from **SUMMUM PRO** chimney pipe.



EXTENSION FOR SC-6IAIS-2  
SC-6IAISE-2 (10")



INSULATED AND ADJUSTABLE  
ATTIC SHIELD\* (10" a 19")  
SC-6IAIS-2  
\*(Included: Collar)

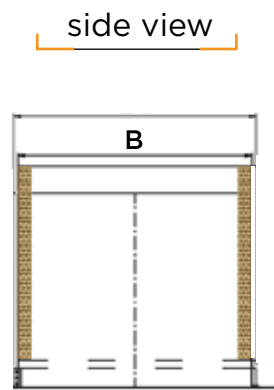
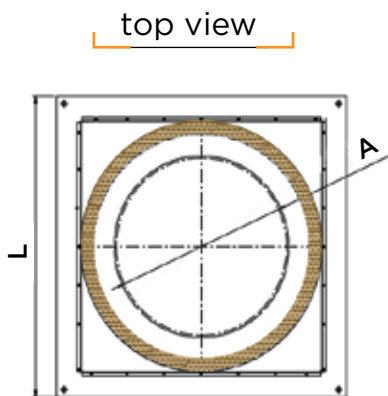

 = PIECE WITH INSULATION

Inch	A	B	L
6"	9"	13"	15 3/8"

## INSULATED ROOF RADIATION SHEILD\* (cathedral)

The insulated roof radiation shield is used to keep any combustible material from coming into contact with the chimney pipe.



### INSULATED ROOF RADIATION SHEILD\* (cathedral)

SC-6IRRS-2-P

\*(Included: Collar, Borders)

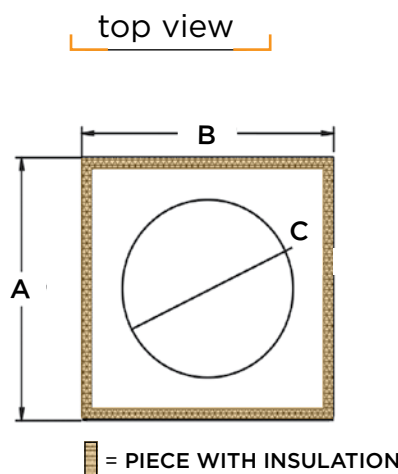

side view



Inch	A	B	C	L
6"	13"	13"	9"	36"

## ROOF SUPPORT

The roof support is designed to support the **SUMMUM PRO** chimney pipe at the roof line. It can be used to extend the chimney below a cathedral ceiling, above an offset or provide additional support when the chimney height exceeds the capacity of the main support. It adjusts easily to any roof pitch. **304 Stainless steel** band with galvanized mounting brackets.



### ROOF SUPPORT

SC-6RFS-2

top view

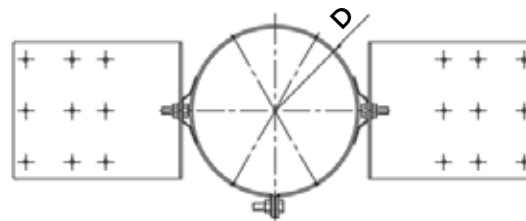

side view

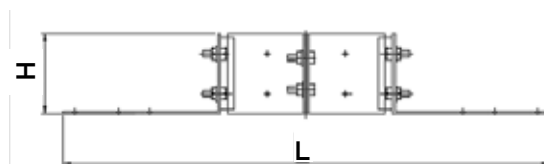

Inch	D	L	H
6"	9"	21"	4"



VENTED ROOF FLASHING\* (0°)

Made of **304 stainless steel**, the **SUMMUM PRO** vented roof flashing makes it possible to seal the roof at the connection points and provides additional air circulation required by certain appliances.



VENTED ROOF FLASHING\* (0°)  
SC-6FRF  
\*(Included: Storm Collar)

top view

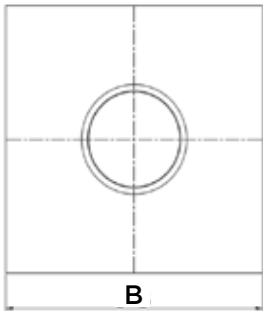

side view

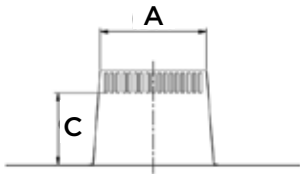

Inch	A	B	C
6"	9"	23 1/2"	6"

VENTED ROOF FLASHING\* (from 1/12 - 7/12), (5° - 30°)

Made of **304 stainless steel**, the **SUMMUM PRO** vented roof flashing makes it possible to seal the roof at the connection points and provides additional air circulation required by certain appliances.



VENTED ROOF FLASHING\* (from 1/12 - 7/12), (5° - 30°)  
SC-6RF01  
\*(Included: Storm Collar)

top view

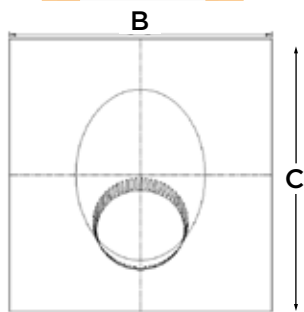

side view

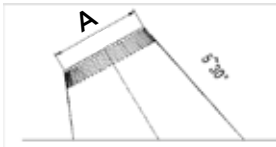

Inch	A	B	C
6"	9"	23 1/2"	27 1/2"

**VENTED ROOF FLASHING\*** (Included: Storm Collar) (from 7/12 - 12/12), (30° - 45°)

Made of **304 stainless steel**, the **SUMMUM PRO** vented roof flashing makes it possible to seal the roof at the connection points and provides additional air circulation required by certain appliances.



top view

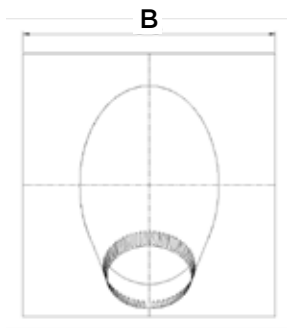

side view



Inch	A	B	C
6"	9"	23 1/2"	27 1/2"

**VENTED ROOF FLASHING\*** (from 7/12 - 12/12), (30° - 45°)  
SC-6RF02  
\*(Included: Storm Collar)

**VENTED ROOF FLASHING\*** (from 12/12 - 21/12), (45° - 60°)

Made of **304 stainless steel**, the **SUMMUM PRO** vented roof flashing makes it possible to seal the roof at the connection points and provides additional air circulation required by certain appliances.



top view

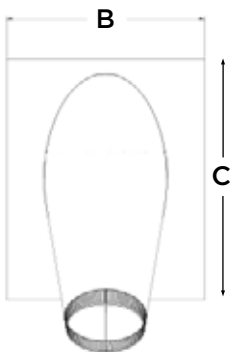

side view

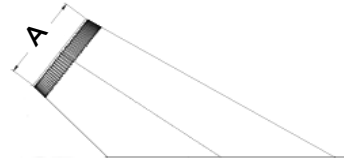

Inch	A	B	C
6"	9"	23 1/2"	27 1/2"

**VENTED ROOF FLASHING\*** (from 12/12 - 21/12), (45° - 60°)  
SC-6RF03  
\*(Included: Storm Collar)





VENTED AND ADJUSTABLE PINION FLASHING\* (from 4/12 à 21/12), (de 5° - 60°)

Made of **304 stainless steel**, the **SUMMUM PRO** vented and adjustable peak flashing is required when the chimney passes through the peak of the home. It is designed to fit any roof pitch from 4/12 until 21/12.



top view

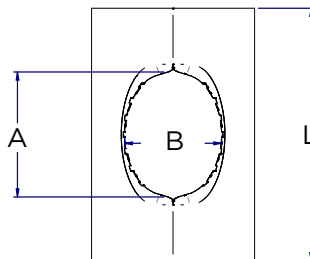

side view

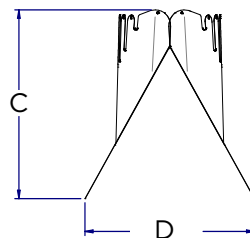

Inch	A	B	C	D	L
6"	11 1/2"	9"	17"	16"	23 1/2"

VENTED AND ADJUSTABLE PINION FLASHING\* (from 4/12 - 21/12), (5° - 60°)

SC-6APF

\*(Included: Collar)

EXTENDED ROOF BRACKET

The extended roof bracket is used to support the **SUMMUM PRO** chimney which extends more than 5 feet above the roof. The poles adjust between 5 and 10 feet and adapt to any roof pitch. The ring is made of **304 stainless steel** while the poles are made of galvanized steel.



top view



side view

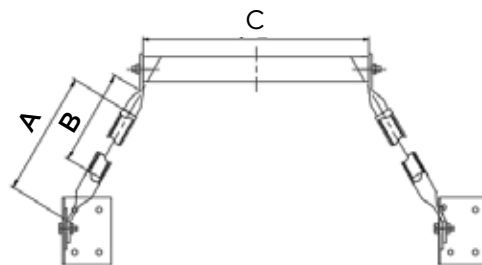

Inch	A	B	C
6"	120"	60"	9"

EXTENDED ROOF BRACKET

SC-6ERB

STORM COLLAR

Made of **304 stainless steel**, the storm collar is designed to fit the exact size of the **SUMMUM PRO** chimney and make it waterproof.



STORM COLLAR  
SC-6SC

top view

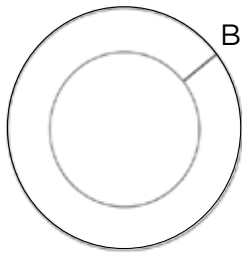

side view

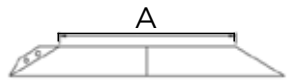

Inch	A	B
6"	9"	4"

STORM COLLAR XL

Made of **304 stainless steel**, the storm collar xl is designed to fit the exact size of the **SUMMUM PRO** chimney and make it waterproof.



STORM COLLAR XL  
SC-6SCXL

top view

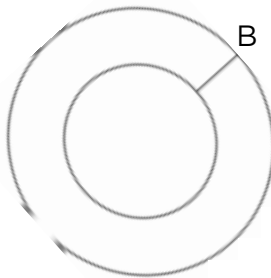

side view

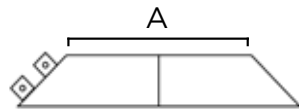

Inch	A	B
6"	9"	5 1/4"



FLUE EXTENSION

The **SUMMUM PRO** flue extension is designed to connect to the first chimney length with 3 screws. With this piece, you can connect a stove pipe or any type of connector to the **SUMMUM PRO** chimney. The flue extension can also be used to connect a SUMMUM PRO chimney directly to a device.



**FLUE EXTENSION**  
SC-6ADP-P

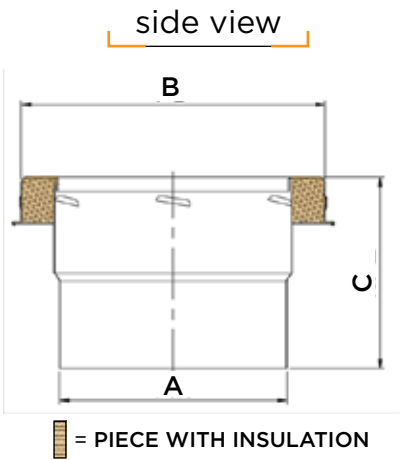

Inch	A	B	C
6"	6"	9"	4 3/4"

INSULATED SQUARE CEILING SUPPORT\* (IDEAL FOR CATHEDRAL INSTALLATION)

The **SUMMUM PRO** insulated square ceiling support can be installed on both sloped and cathedral roofs. It must extend at least 3 inches into the room from the ceiling. It also serves as a support and attic radiation shield. The insulated square ceiling support is designed to support up to 45 feet of **SUMMUM PRO** chimney. Made of type 430 stainless steel and black painted galvanized steel. The insulated square ceiling support includes the edge, flue extension and collar.



**INSULATED SQUARE CEILING SUPPORT\***  
SC-6ISCS16-2-P • SC-6ISCS24-2-P  
SC-6ISCS36-2-P

\*(Included: Collar, Trims, Flue Extension)

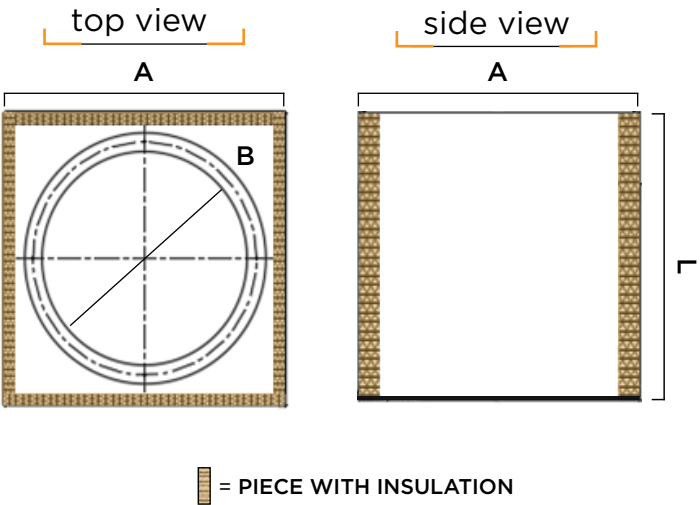

Inch	A	B	L
6"	13"	6"	16", 24", 36"

ROUND CEILING SUPPORT\*

The **SUMMUM PRO** round ceiling support, must be installed on flat roofs. It must extend at least 3 inches into the room from the ceiling. It also serves as a support and a attic radiation shield. The round ceiling support is designed to support up to 45 feet of **SUMMUM PRO** chimney. Made of type 430 stainless steel and black painted galvanized steel. The round ceiling bracket includes the edge, flue extension and collar.



ROUND CEILING SUPPORT\*

SC-6RCS16-2-P

\*(Included: Collar, Trims, Flue Extension)

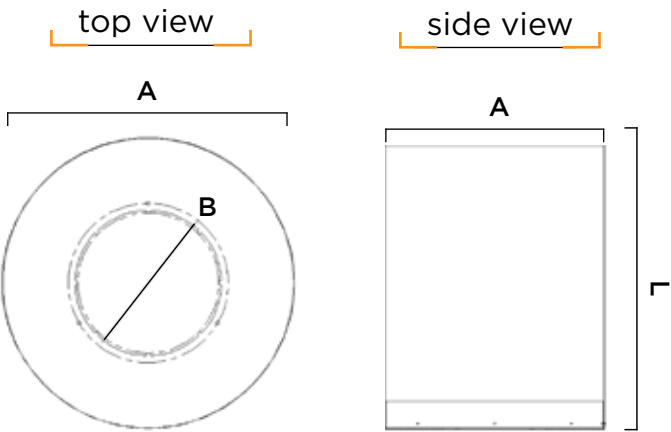

Inch	A	B	L
6"	13"	6"	16"

INSULATED ROUND CEILING SUPPORT\*

The **SUMMUM PRO** insulated round ceiling support, must be installed on flat roofs. It must extend at least 3 inches into the room from the ceiling. It also serves as a support and a attic radiation shield. The insulated round ceiling support is designed to support up to 45 feet of **SUMMUM PRO** chimney. Made of type 430 stainless steel and black painted galvanized steel. The insulated round ceiling support includes the edge, flue extension and collar.



INSULATED ROUND CEILING SUPPORT\*

SC-6IRCS16-2-P

\*(Included: Collar, Trims, Flue Extension)

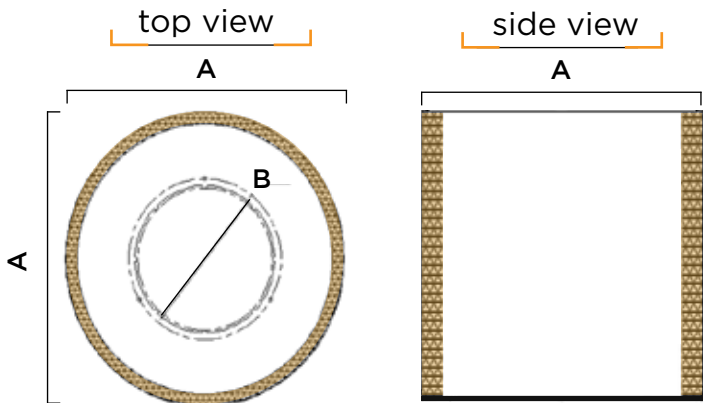

Inch	A	B	L
6"	13"	6"	16"

BLACK FINISHING TRIM

The **SUMMUM PRO** black finishing trim strip is used to cover a chimney section that passes through a wall thimble.



**BLACK FINISHING TRIM**  
SC-6BFT

top view

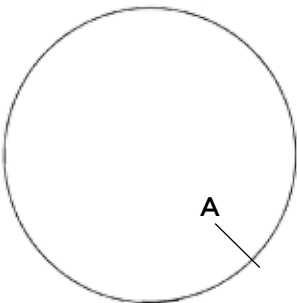

side view

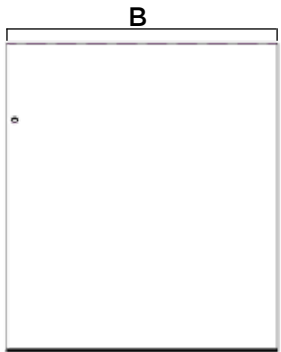

Inch	A	B
6"	9"	7 <sup>7</sup> / <sub>8</sub> "

INSULATED WALL THIMBLE (from 8" to 15<sup>1</sup>/<sub>2</sub>" )

The **SUMMUM PRO** insulated wall thimble must be used when a chimney passes a combustible wall horizontally. It is telescopic so it can fit walls from 8" to 15<sup>1</sup>/<sub>2</sub>" thick. This **SUMMUM PRO** insulated wall thimble is manufactured to be installed in energy efficient homes with watertight seals to prevent condensation.

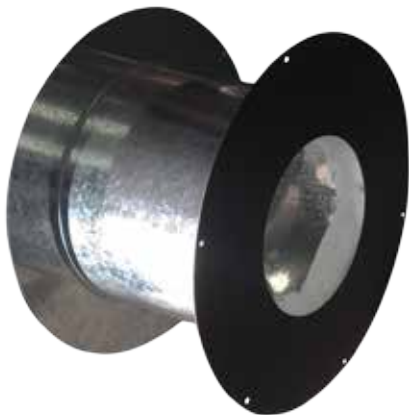

**INSULATED WALL THIMBLE** (from 8" to 15<sup>1</sup>/<sub>2</sub>" )  
SC-6IWT-2-P

top view

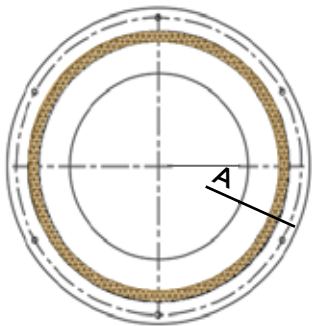

side view

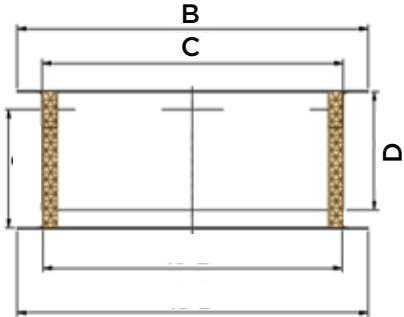

 = PIECE WITH INSOLATION

Inch	A	B	C	D
6"	5"	19"	13"	8"

## ROOF RADIATION SHIELD (IDEAL FOR CATHEDRAL INSTALLATION)

The **SUMMUM PRO** attic radiation shield can be used when the **SUMMUM PRO** chimney extend through a sloped ceiling. It can be adjusted for all angles.



top view



side view

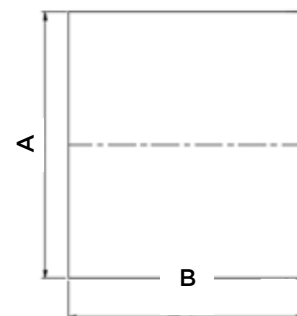

**ROOF RADIATION SHIELD**  
SC-6RRS-2

Inch	A	B
6"	15"	13"

## RAIN CAP WITH SHIELD

The **SUMMUM PRO** rain cap with shield is made of type **304 stainless steel**. It helps to retain sparks and embers and protects against weather infiltration. It also prevents small animals from entering.



side view

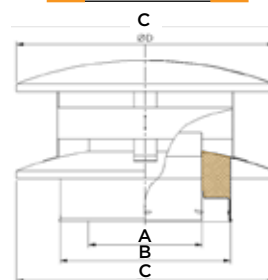

**RAIN CAP WITH SHIELD**  
SC-6RC02

 = PIECE WITH INSULATION

Inch	A	B	C
6"	6"	9"	13 3/4 "



Various parts are available on special order for specific types of installations.

TRIM RING

The **SUMMUM PRO** trim ring is used to hide the space between the chimney and a noncombustible wall.



TRIM RING  
SC-6TR

top view

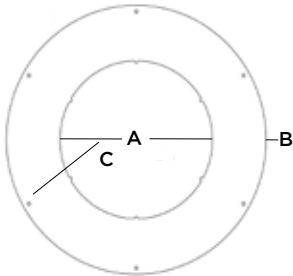

Inch	A	B	C
6"	9"	15 3/4"	3 3/4"

ANCHOR PLATE

The **SUMMUM PRO** anchor plate is used to connect an appliance to a **SUMMUM PRO** chimney (prefabricated fireplace, masonry fireplace or space heater).



ANCHOR PLATE  
SC-6AN01

top view

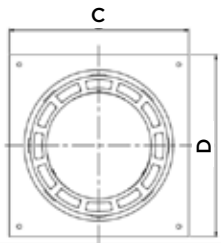

side view

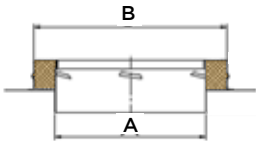

 = PIECE WITH INSULATION

Inch	A	B	C	D
6"	6"	9"	11"	13"

# OUTDOOR STARTING KIT

## PARTS CONTAINED IN THE OUTDOOR STARTER KIT



1. Tee with Cap\*- SC-6T90
2. Insulated Wall Thimble - SC-6IWT-2-P
3. Rain Cap with Shield - SC-6RC02
4. Flue Extension - SC6ADP-P
5. Adjustable Wall Support and Tee Bracket 5 inches (2) - SC-6AWB
6. Black Finishing Trim - SC-6BFT

## OUTDOOR STARTING KIT SC-EDE

\*(Included: Locking Bands)

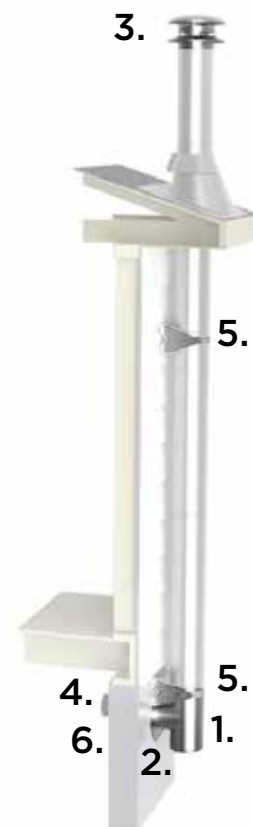

## INDOOR STARTING KIT



1. Rain Cap with Shield - SC-6RC02  
2. Round Ceiling Support\* - SC-6RCS16-2-P

### INDOOR STARTING KIT

SC-EDI

\*(Included: Collar, Trims, Flue Extension)



CONTENT

PIECES

INSTALLATIONS

## CATHEDRAL STARTING KIT



1. Rain Cap with Shield - SC-6RC02  
2. Insulated Square Ceiling Support\* - SC-6ISCS24-2-P

### CATHEDRAL STARTING KIT

SC-EDC

\*(Included: Collar, Trims, Flue Extension)



# CATHEDRAL INSTALLATION

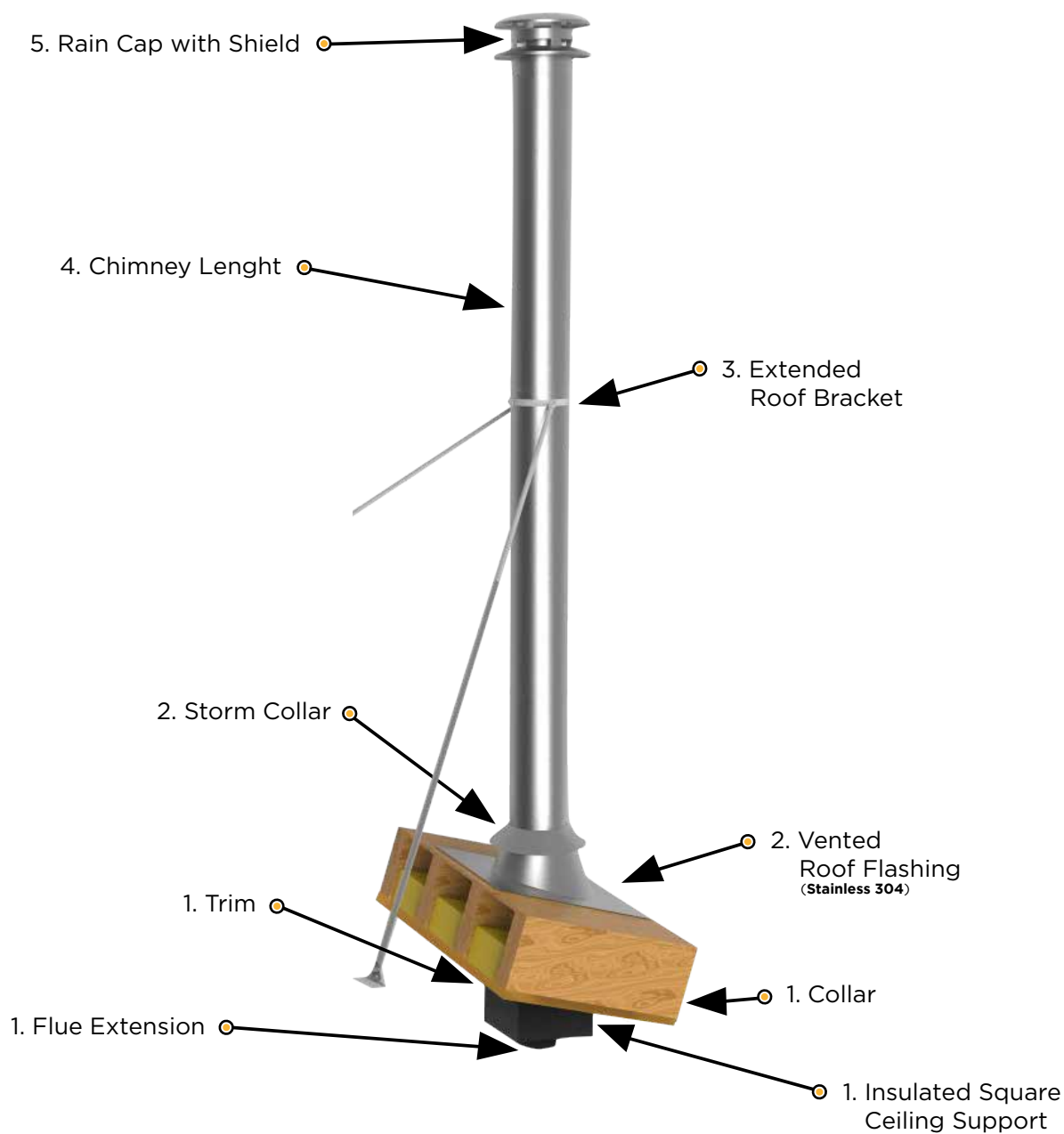

\*Pictures for information only.

## PARTS REQUIRED FOR THIS INSTALLATION



# CATHEDRAL INSTALLATION

## IN THE BASEMENT

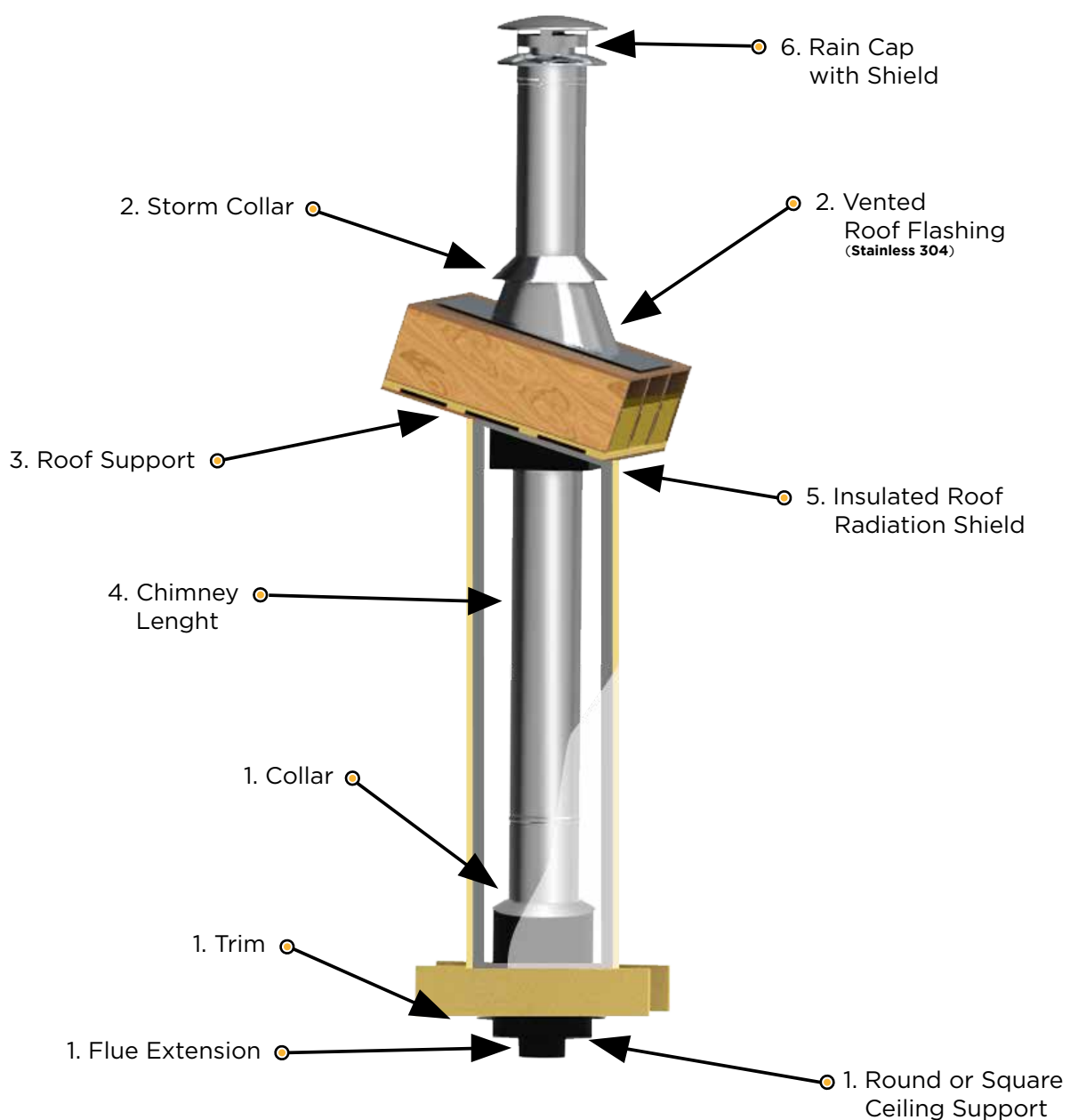

\*Pictures for information only.

\*For installations that pass through an inhabited room, the chimney must be nested.

### PARTS REQUIRED FOR THIS INSTALLATION



# ONE STOREY INSTALLATION

WITH CEILING SUPPORT

ABOUT US

PIECES

INSTALLATIONS

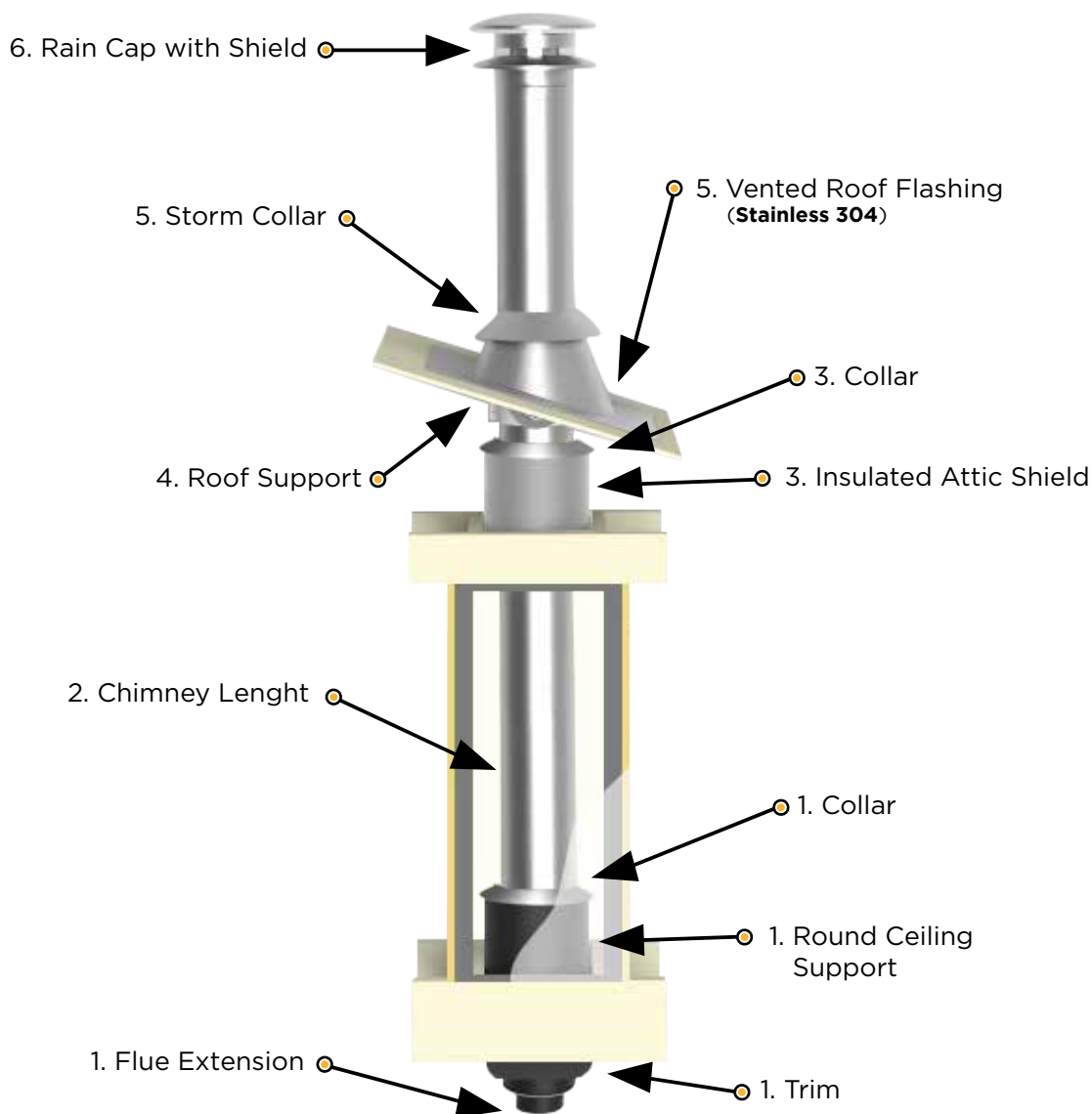

\*Pictures for information only.

\*For installations that pass through an inhabited room, the chimney must be nested.

## PARTS REQUIRED FOR THIS INSTALLATION





# TWO STOREY INSTALLATION

## WITH CEILING SUPPORT

CONTENT

PIECES

INSTALLATIONS

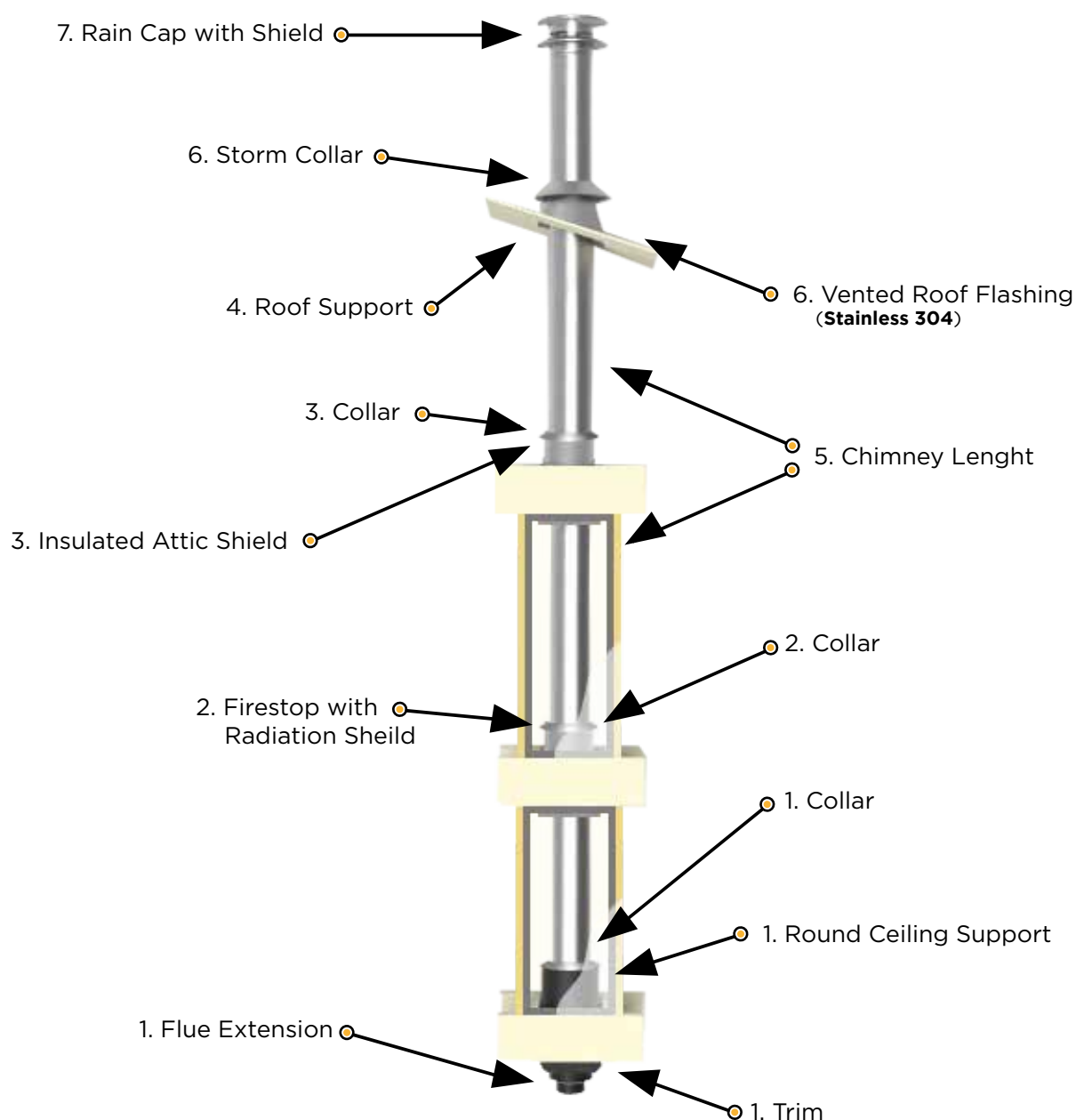

\*Pictures for information only.

\*For installations that cross a living room, the chimney must be nested.

### PARTS REQUIRED FOR THIS INSTALLATION



# THREE STOREY INSTALLATION

WITH CEILING SUPPORT

ABOUT US

PIECES

INSTALLATIONS

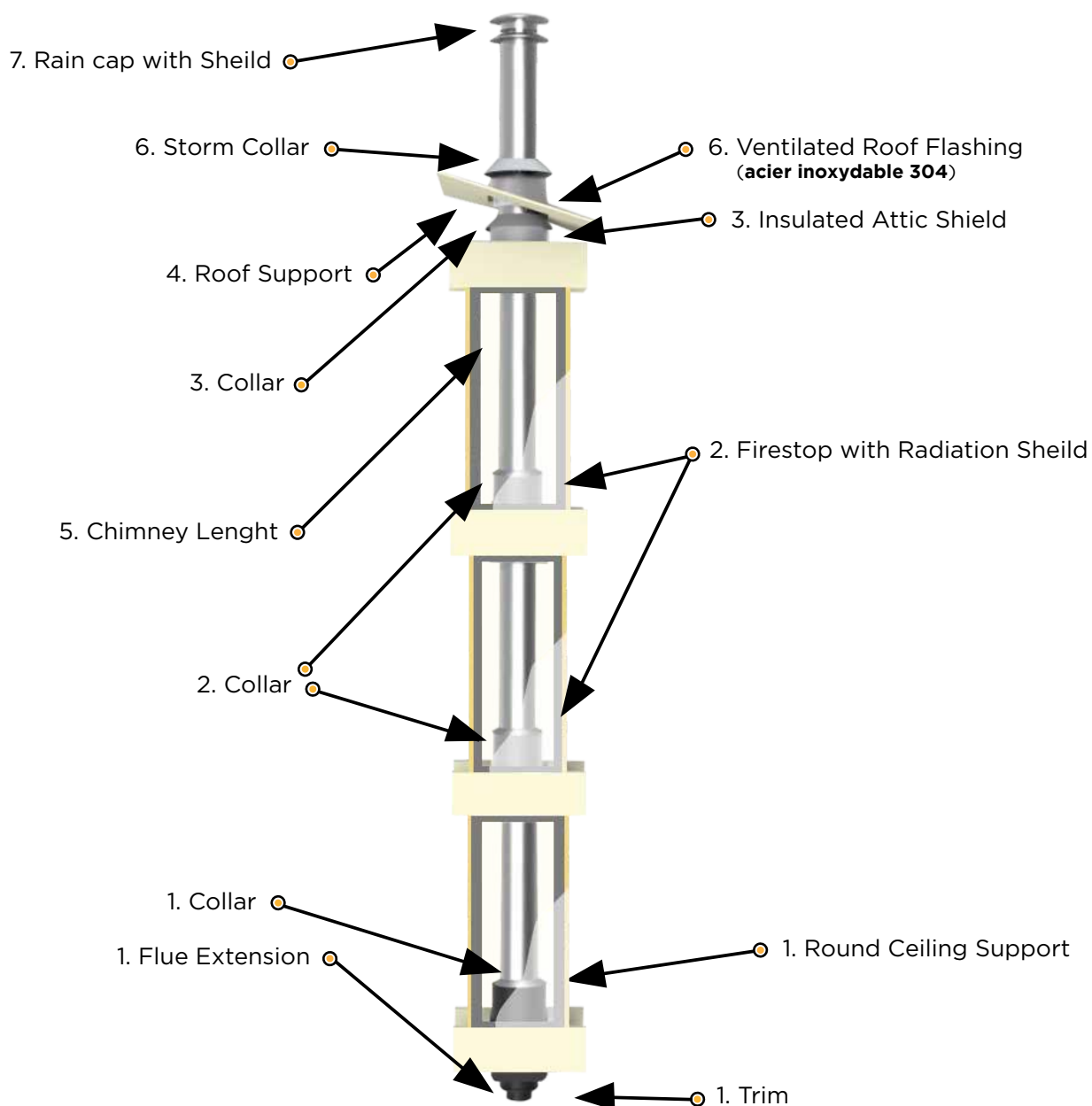

\*Pictures for information only.

\*For installations that cross a living room, the chimney must be nested.

## PARTS REQUIRED FOR THIS INSTALLATION



# EXTERNAL INSTALLATION

WITH WALL BRACKET EXTENSION UP TO 16 INCHES

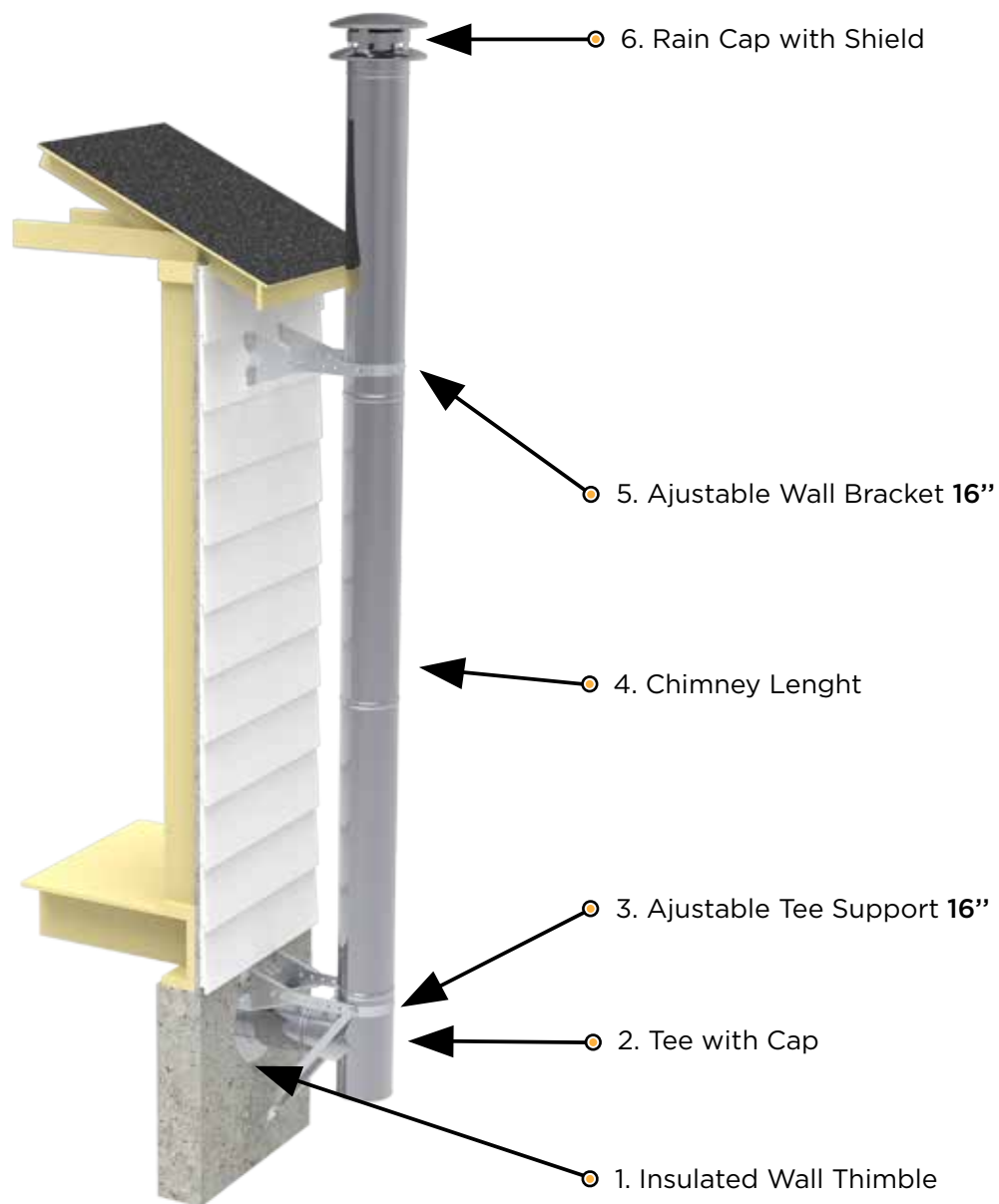

\*Pictures for information only.

## PARTS REQUIRED FOR THIS INSTALLATION



CONTENT

PIECES

INSTALLATIONS

# EXTERNAL INSTALLATION

## THROUGH THE ROOF EXTENSION

ABOUT US

PIECES

INSTALLATIONS

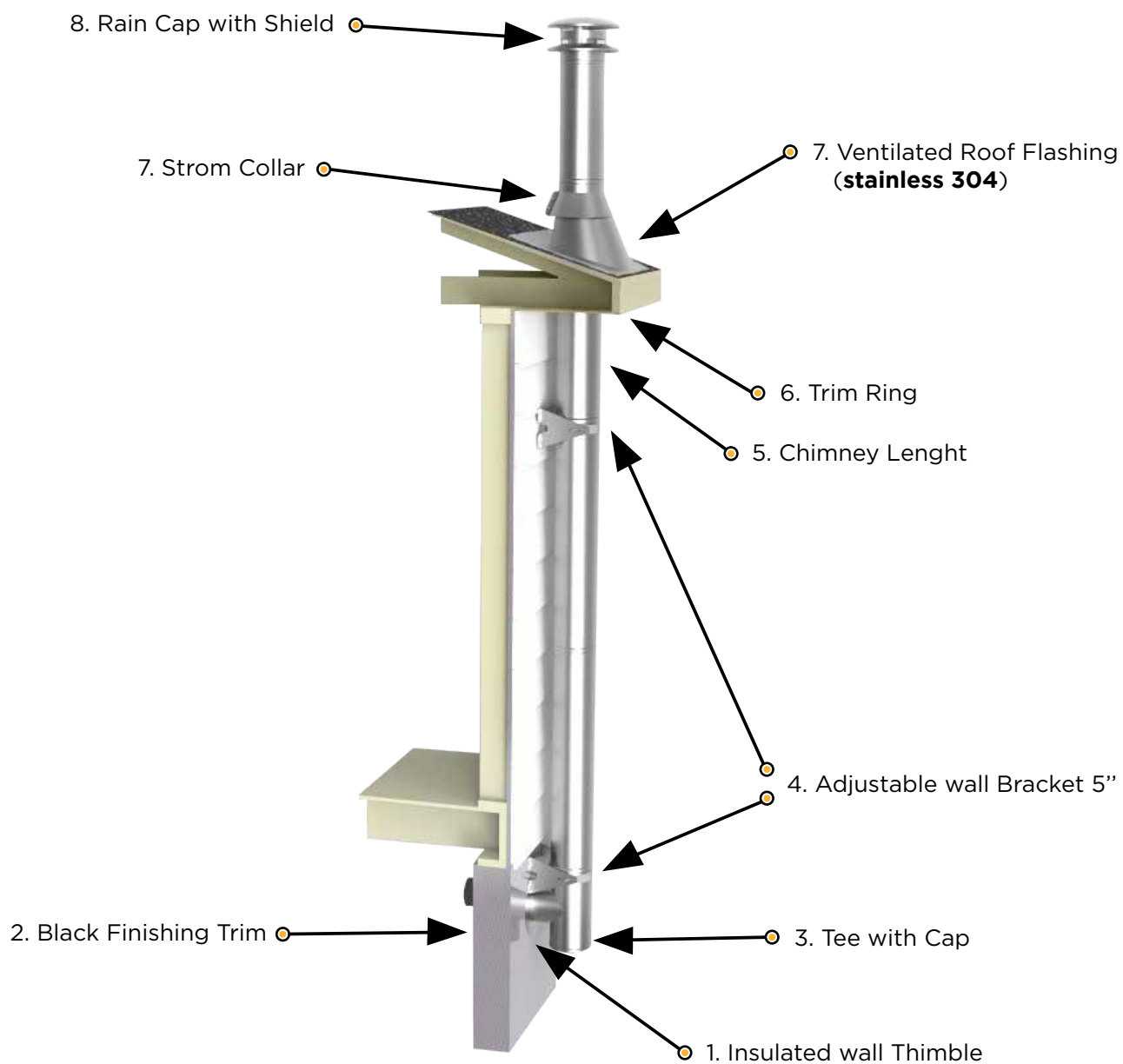

\*Pictures for information only.

### PARTS REQUIRED FOR THIS INSTALLATION



# INSTALLATION WITH DEFLECTION

CONTENT

PIECES

INSTALLATIONS

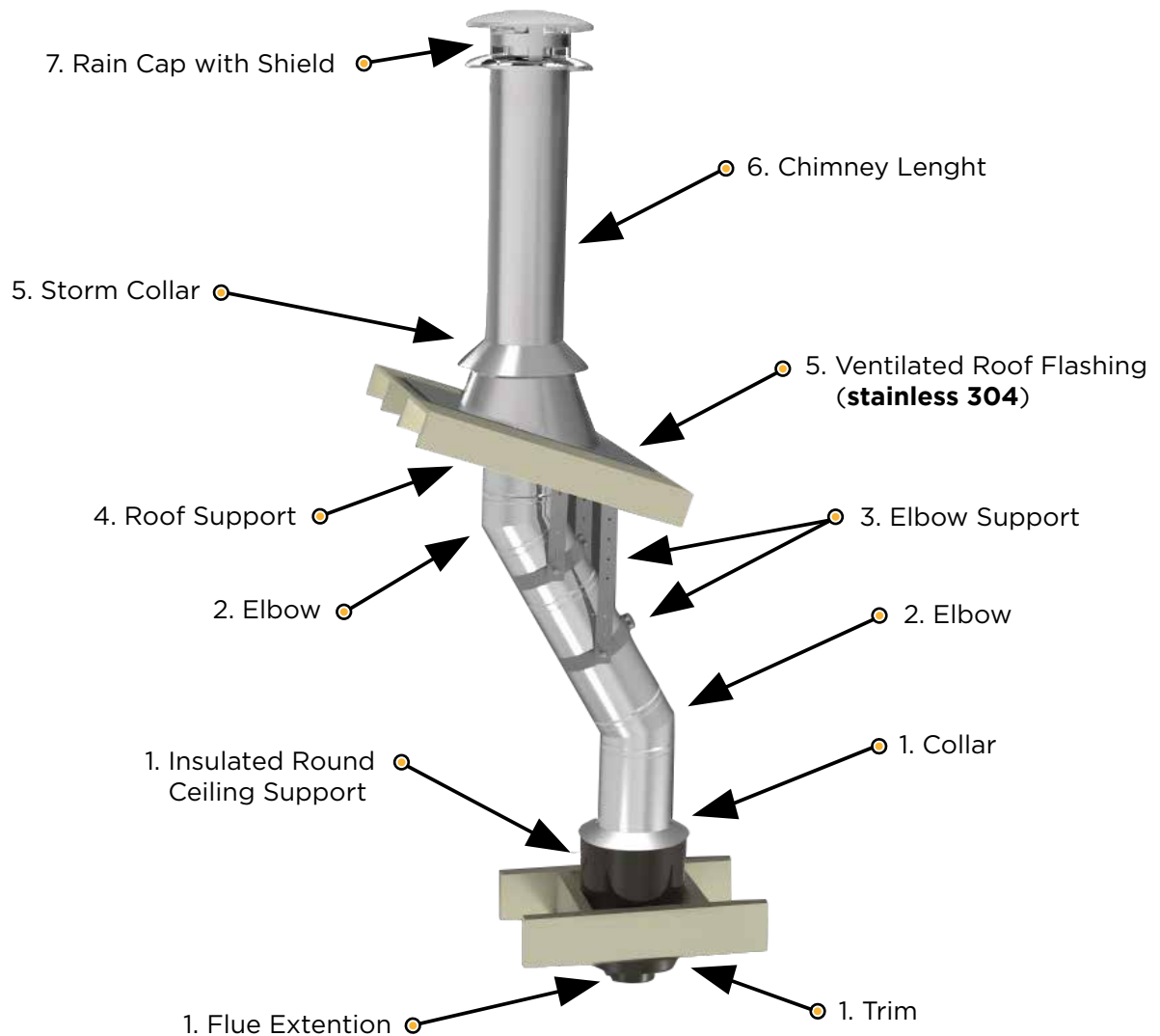

\*Pictures for information only.

## PARTS REQUIRED FOR THIS INSTALLATION





**PREMIUM**  
DISTRIBUTION

1 418 906-8095 | [www.premiumdistribution.ca](http://www.premiumdistribution.ca)  
#100 - 480, rue de l'Argon Quebec, (QC) CANADA G2N 2C9.

In order to provide the highest standards of quality, features and options as well as dimensions and specifications are subject to change due to continuous improvements to our products. Refer to the instruction manual for complete installation instructions and clearance requirements to combustible materials. Facilities must comply with applicable local and national building codes.

Printed in Canada



0003\_2020\_V\_20.5